

Südmetall®



ÜLOCK

LOCKING SYSTEMS
MAIN CATALOGUE **2021**

ÜLOCK	LOCKS
Ü HANDLE	
STANDALONE SOLUTIONS	
STRIKE	PLATESS
Ü L I N D E R	
Ü MANAGEMENT	
Ü LOCK	BLE
SWITCHING	MODE
POWER	SUPPLY



SÜDMETALL stands for...

...Expertise, experience and excellent service. The company Süd-Metall Schließsysteme Leipzig GmbH was established in the year 2013 as a division of the Almar Südmetall Group. Süd-Metall Schließsysteme Leipzig GmbH focuses on developing and producing electronic access solutions based on electro-mechanical locks "Made in Germany".

In their daily work our staff is guided by the company values of "competence, reliability and fairness" with a strong focus on customer service. Südmetall already leads

the market in the German-speaking world in the product range of fittings and metal and glass construction. The many years of market experience of the Almar Südmetall Group and the know-how of the development engineers in the field of locking systems produce synergy effects that are reflected in the quality of the products.

The concentration of development and production at the Leipzig site allows an optimisation of the development times and facilitates the subsequent commercial launch.



metall®

COMPONENTS

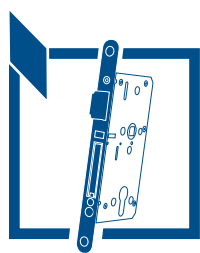

ÜLOCK



ÜHANDLE

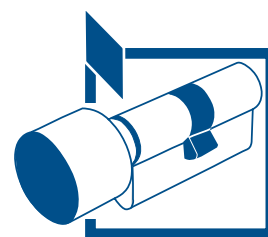

ÜLINDER

SYSTEMS



STAND ALONE

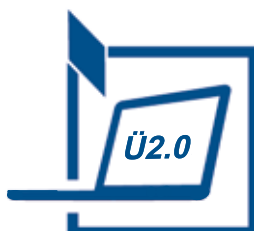

ÜMANAGEMENT 2.0.



ULOCK

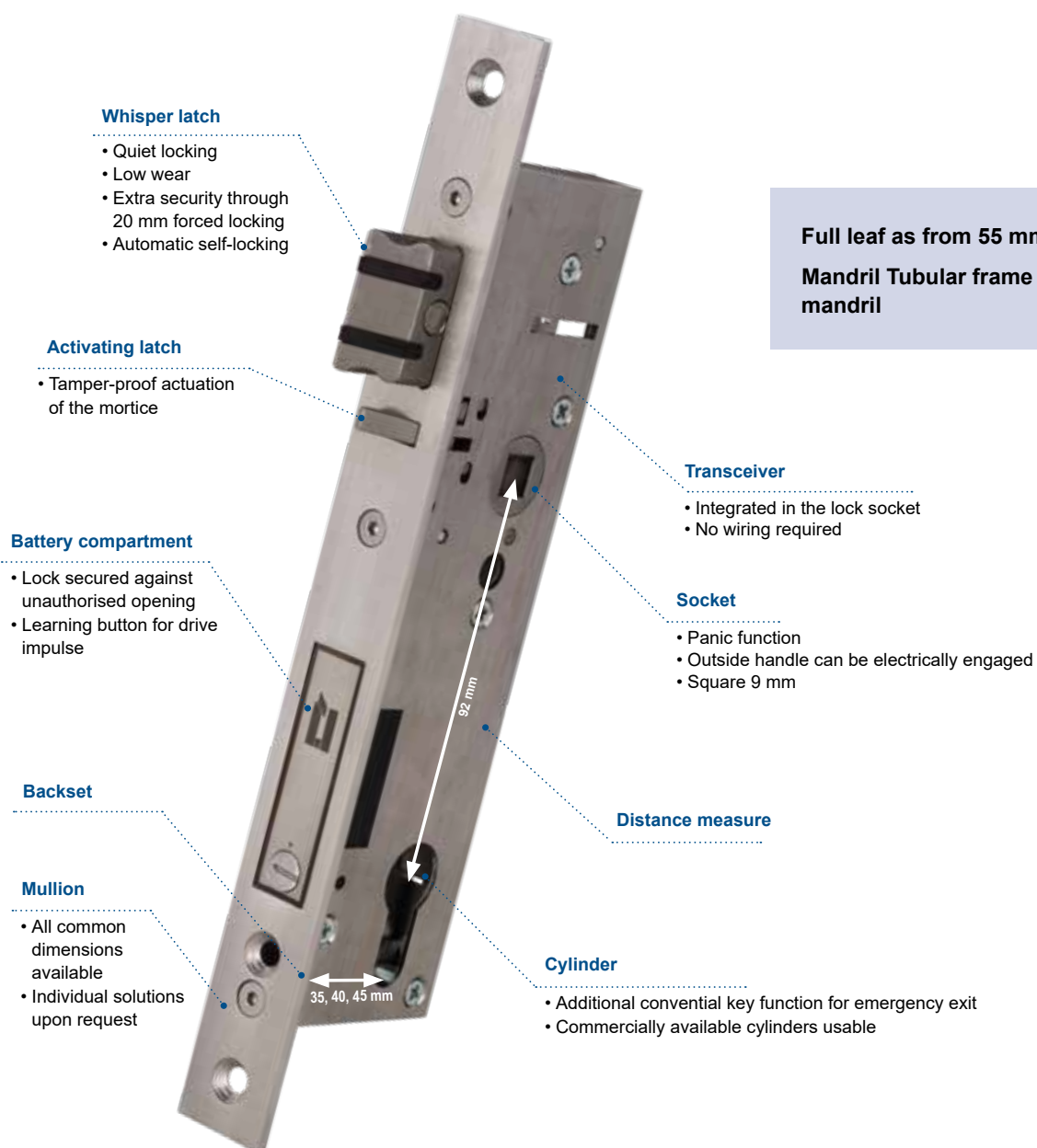

Full leaf as from 55 mm

Mandril Tubular frame as of 35 mm mandril



ÜLOCK-B

SECURITY ON BOTH SIDES OF THE DOOR

- **Outside handle can be connected electrically**
- **Lifesaving panic function in direction of escape**
- Protects tangible assets from unauthorised outside access
 - Automatic self locking: Door is always locked by a 20 mm whisper latch
 - Anti-burglary protection: High resistance category of the lock against mechanical manipulation
 - No attack surface from the outside, the electronics is completely enclosed in the lock case
 - Coded data transfer between the lock and the drive system (AES 128)

COMFORT AND DESIGN

- Free selection of the mounting to suit building design
- Standalone version or system solution
- Mechanical emergency exit using cylinder key at all times

PERFECT FOR RETROFITTING

- Can be used for emergency fire doors
- No wiring of the door required (ÜLock-B Battery + Inductive)
- Can be used with other makes of drive systems
- Easily combinable with existing profile cylinders, fittings and drive systems
- Available in all common sizes

ACCESS CONTROL ON BOTH SIDES OF THE DOOR

- **Both door handles can be connected electronically**
- **NO panic function**
- Protects tangible assets from unauthorised outside access
 - Automatic self locking: Door is always locked by a 20 mm whisper latch
 - Anti-burglary protection: High resistance category of the lock against mechanical manipulation
 - No attack surface from the outside, the electronics is completely enclosed in the lock case
 - Coded data transfer between the lock and the drive system (AES 128)

COMFORT AND DESIGN

- Free selection of the fittings to suit building design
- Standalone version or system solution
- Mechanical emergency exit using cylinder key at all times

PERFECT FOR RETROFITTING

- Can be used for emergency fire doors
- No wiring of the door required (ÜLock-B Battery + Inductive)
- Compatible with other makes of drive systems
- Easily combinable with existing profile cylinders, fittings and drive systems
- Available in all common sizes

ÜLOCK-N

Premium: Including EN 1634-1, EN 179, EN 1125, EN 14846 tests

Comfort: Without tests

T A B L E O F C O N T E N T S



ÜLOCK BATTERY

PAGE

10

- Battery contained in the lock case
- Full leaf, tubular frame, glass door versions



ÜLOCK INDUCTIVE

PAGE

12

- Inductive energy transfer without battery or door leaf wiring
- Full leaf and tubular frame versions



GLASS DOOR LOCK

PAGE

14

ÜLock Battery for glass doors



ÜLOCK CABLE

PAGE

18

- Door leaf wiring
- Full leaf version



ÜLOCK BASIC

PAGE

23

- Mechanical version:
Outside handle can be engaged mechanically using the profile cylinder. Full leaf version



STAND ALONE SOLUTIONS

PAGE

16



STRIKE PLATESS

PAGE

24



ÜLINDER

PAGE

28



ÜHANDLE

PAGE

32



EXPOSED BATTERY KEYPAD

PAGE

40



VOXIO TOUCH

PAGE

42



ÜLOCK MOBILE ACCESS

PAGE

44



ÜMANAGEMENT 2.0

PAGE

46



DISPLAY STAND

PAGE

50



FITTINGS

PAGE

52



SWITCHING POWER SUPPLY

PAGE

56



RFID IDENT MEDIA

PAGE

58



ORDERING INFORMATION

PAGE

60



CONTACTS

PAGE

62





Together we

INNOVATE

Access

SOLUTIONS

ÜLOCK BATTERY FULL LEAF



FULL LEAF Comfort or premium

Product features for ÜLock-B and ÜLock-Z:



- › Self locking, whisper latch 20 mm (stainless steel)
- › Remote control and electronics protection in the lock case
- › Tamper-proof, programming key integrated in the battery compartment, this can only be opened with a cylinder key
- › Up to 99 access authorisations can be assigned to each lock
- › Radio frequency: 868,3 MHz / Coding AES 128
- › Standard long-life batteries (AAA Energizer Ultimate Lithium)

Specification ÜLock-B:

- › Outside handle can be engaged electrically
- › Premium version incl. certificates: EN 179 / EN 1125
EN 1634-1 / EN 14846
- › Panic function

Specification ÜLock-Z:

- › Both handles can be engaged electrically
- › No panic function!
- › Premium version incl. certificates:
EN 1634-1 / EN 14846

Distance	Backset	Flying mullion (polished stainless steel) Standard rounded			
 DIN PZ					
		20x235x3	24x235x3	20x280x3	24x280x3
72	55	X	X		
72	60	X	X		
72	65	X	X		
72	80	X	X		
92	65			X	X
92	80			X	X
 Ö-Norm PZ					
		18x250x3	20x250x3	20x300x3	
88	55	X	X	X	
88	60	X	X	X	
88	65	X	X	X	
88	70	X	X	X	
 RZ					
		20x235x3	24x235x3	18x230x3	20x230x3
74	65	X	X		
78	60			X	X
78	70			X	X
78	80			X	X

Highlighted in blue = In-stock items (readily available)



TUBULAR FRAME

Comfort or premium

Product features of ÜLock-B and ÜLock-Z:

- › Self locking, whisper latches 20 mm (stainless steel)
- › Remote control and electronic protection in the lock case
- › Tamper-proof, programming key integrated in the battery compartment; requires cylindrical key to open
- › Up to 99 access authorisations can be assigned to each lock
- › Radio frequency: 868,3 MHz / Coding AES 128
- › Standard long-life batteries (Standard lithium battery 1/2 AA 3,6V)

Specification ÜLock-B:

- › Outside handle can be engaged electrically
- › Premium version incl. certificates: EN 179 / EN 1634-1 EN 14846
- › Panic function

Specification ÜLock-Z:

- › Both handles can be engaged electrically
- › No panic function!
- › Premium version incl. certificates: EN 1634-1

Distance Backset Flying mullion (polished stainless steel)
Standard angular

DIN PZ		Ö-Norm PZ		
		24x245x3	24x270x3	28x270x3
92	35	X	X	X
92	40	X	X	X
92	45	X	X	X

RZ		24x245x3	24x270x3	28x270x3
94	35	X	X	X
94	40	X	X	X
94	45	X	X	X

Highlighted in blue = In-stock items (readily available)

Strike plates are **NOT** included.

Suitable strike plates are shown on PAGE 24.



FULL LEAF Comfort or premium

Product features of ÜLock-B and ÜLock-Z:



- › Self locking, whisper latch 20 mm (stainless steel)
- › Remote control and electronic protection in the lock case
- › Up to 99 access authorisations can be assigned to each lock
- › Radio frequency: 868,3 MHz / Coding AES 128
- › Inductive energy transfer - no battery replacement and no wiring of the door leaf required

Spezifikation ÜLock-B:

- › Outside handle can be engaged electrically
- › Premium incl. certificates: EN 179 / EN 1125 EN 1634-1

Specification ÜLock-Z:

- › Both handles can be engaged electrically
- › No panic function!
- › Premium version incl. certificates: EN 1634-1

Distance	Backset	Flying mullion (polished stainless steel) Standard rounded			
 DIN PZ					
		20x235x3	24x235x3	20x280x3	24x280x3
72	55	X	X		
72	60	X	X		
72	65	X	X		
72	80	X	X		
92	65			X	X
92	80			X	X
 Ö-Norm PZ					
		18x250x3	20x250x3	20x300x3	
88	55	X	X	X	
88	60	X	X	X	
88	65	X	X	X	
88	70	X	X	X	
 RZ					
		20x235x3	24x235x3	18x230x3	20x230x3
74	65	X	X		
78	60			X	X
78	70			X	X
78	80			X	X

Highlighted in blue = In-stock items (readily available)

World first
Inductive energy transfer
without battery. Wireless.



TUBULAR FRAME Comfort or premium

Product features of ÜLock-B and ÜLock-Z:

- › Self locking, whisper latch 20 mm (stainless steel)
- › Remote control and electronic protection in the lock case
- › Up to 99 access authorisations can be assigned to each lock
- › Radio frequency: 868,3 MHz / Coding AES 128
- › Inductive energy transfer - no battery replacement and no wiring of the door leaf required

Specification ÜLock-B:

- › Outside handle can be engaged electrically
- › Premium incl. certificates: EN 179 / EN 1634-1 EN 14846

Specification ÜLock-Z:

- › Both handles can be engaged electrically
- › No panic function!
- › Premium version incl. certificates: EN 1634-1 / EN 14846

Distance Backset Flying mullion (polished stainless steel)
Standard angular

		DIN PZ			Ö-Norm PZ		
		24x245x3			24x270x3		
		24x270x3			28x270x3		
92	35	X	X	X	X	X	X
92	40	X	X	X	X	X	X
92	45	X	X	X	X	X	X

		RZ					
		24x245x3			24x270x3		
		24x270x3			28x270x3		
94	35	X	X	X	X	X	X
94	40	X	X	X	X	X	X
94	45	X	X	X	X	X	X

Highlighted in blue = In-stock items (readily available)

Striking plates not included.

ÜLOCK GLASS DOOR

SINGLE SOURCE - THAT IS SÜDMETALL

I/O MODUL

The I/O module allows existing access systems to communicate with Südmetail locking system products. Existing systems can be combined with new systems allowing an easy retrofitting of ÜLock locks.



Drive system

- › Keypad, RFID, fingerscan enabled
- › Remote control activated using handheld transmitter

(Information on the systems starts on PAGE 16)

Glass door hinges

- › available as 2 or 3 part sets

(Additional glass door hinges are shown in our fittings catalogue“)

Fittings

- › Top Speed or Flat fittings can be used

(A large variety of different designs are also shown in our catalogue „Faszination Beschläge“)

Frame receptacles

- › Wooden or steel frames

(Additional information available in the catalogue „Faszination Beschläge“)

Combinations with the wide range of fittings:



Ronny-R



Madrid-R



Paula-R



Jill-R



Erika-R



Alaska-R

Südmetail offers a wide variety of door handles. You will find our complete door handle range in the catalogue Faszination Beschläge (Art. No. 36.06.0010). All models of the series Vario Star Top Speed and Flat can be combined with the ÜLock-B Battery for glass doors.



GLASS DOOR LOCK

Comfort

Product features:

- › Distance measure: 72 mm
- › Backset: 55 mm
- › Self locking, whisper latch 20 mm (stainless steel)
- › Remote control and electronics protection in the lock case
- › Tamper-proof, programming key integrated in the battery compartment, this can only be opened with a cylindrical key
- › Up to 99 access authorisations can be assigned to each lock
- › Radio frequency: 868,3 MHz / Coding AES 128
- › Standard long-life batteries (AAA Energizer Ultimate Lithium)
- › Combinable with Vario Star Top Speed and Flat fittings from Südmetall
- › Round cylinder version available

Specification ÜLock-B:

- › Outside handle can be engaged electrically
- › Panic function

Specification ÜLock-Z:

- › Both handles can be engaged electrically
- › No panic function!



STRIKE BOX

Comfort

Product features:

- › For being used together with the glass door lock
- › Stainless steel casing
- › 180 x 96 x 14 mm

..... are ideal for small to medium-sized objects with a manageable number of doors and users that do not have to be interconnected. The relevant drive systems have been optimised for combining with ÜLock-B locks.

This ensures a high safety standard. The lock and the drive system are simply connected together by a learning button located inside the lock case.



BIO KEY RFID

RFID cards/transponders are individually programmed and allow or prevent access to premises such as offices, chambers or hotels. Wireless communication between the drive system and the lock. The outside unit is dust- and water-proof according to IP 65.

Product features:

- › Memory space: teachable for up to 150 cards/transponders
- › Integrated transceiver
- › Operating voltage: 12-24V DC
- › Data transfer coded through AES 128
- › Stainless steel surface



BIO KEY FINGERSCAN

The fingerscan is an optimal solution for small to medium-sized objects since one's own fingerprint is unique and therefore ideal for use in access control systems. There is no more danger of being locked out or of losing a key. The reading surface is permanently temperature-controlled at 29°C and is dust and water-proof according to IP 65. The system features a wireless communication between the drive system and the lock.

Product features:

- › Memory space: teachable for up to 150 fingers
- › Integrated transceiver
- › Operating voltage: 12-24V DC
- › Optional memory space administration
- › Data transfer coded through AES 128
- › Stainless steel surface
- › Radio frequency: 868 MHz

Mains-engagable version (RS485 or TCP/IP) available upon request.



BATTERY SURFACE-MOUNTED KEYPAD

The Bio Key keypad is a practical access solution for small and medium-sized companies and for private households since there is no more danger of being locked out or of losing a key. The reading surface is permanently temperature-controlled at 29°C and is dust and water-proof according to IP 65. Wireless communication between the drive system and the lock.

Product features:

- › High-grade surface-mounted casing
- › Allows up to 99 PIN codings
- › Radio interface integrated in the reader (868 MHz /AES 128 coded)
- › Between 1 and 8-digit user codings selectable
- › Optionally operated by battery or using 12V DC
- › Blue background lighting (not for battery operated version)
- › Different colour options

[Additional information on page 40.](#)





HANDHELD TRANSMITTER

The handheld transmitter offers great operating ease comparable to an automatic remote control. Its AES 128 coding protects against a misuse of the radio signals. The handheld transmitter provides two opening options: short-time opening or long-time opening until cancelled.

Product features:

- › Memory space: teachable with an optional number of locks
- › Radio frequency: 868,3 MHz
- › Battery: lithium button cell CR 2032
- › Data transfer: coded through AES 128
- › Range: up to 5 metres depending on the environment and type of door
- › Opening function: short-time opening for 5 seconds / long-time opening until cancelled



VOXIO TOUCH

This wall reader is battery operated or available with an external mains voltage. Operable standalone or as a system solution using software.

[Additional information on page 42.](#)

Product features:

- › Installation: Either surface mounted or concealed installation, dust- and waterproof (IP 54)
- › Can be used with various card standards:
 - ISO 14443A/B, Legic Prime / Advant
 - Mifare classic / DESFire, INSIDE (only UID)
 - SonyFeliCa (only UID)
- › Up to 320 access authorisations for each reader
- › Remote control interface integrated in the reader (868 MHz / AES 128 coded)
- › Tamper-proof transfer
- › Very simple linkage with the lock
- › No I/O module required
- › Attractive, modern design



I/O MODULE

The I/O module allows existing access systems to communicate with products of Südmittel locking systems. Existing systems can thus be combined with new systems and refitted with ÜLock locks.

Product features:

- › Mains voltage: 12-24V DC
- › Unlocking: short-time opening
long-time opening until cancelled
- › Actuation: non-isolated contact
- › Programming: using programming button in the lock
- › Dimensions: 46 x 46 x 20 mm
- › Installation: flush box
- › Response: ÜLock low battery indicator, outside handle activated
- › Extended latch bolt upon request!



I/O MODULE EWS ECO

The I/O module enables existing access systems to communicate with Südmittel ÜLock-B Inductive. Lock and I/O module are connected by radio signal. Transferred data protected against tampering through an AES 128 coding.

Product features:

- › Mains voltage: 12V DC / 24V DC
- › Unlocking: short-time opening
long-time opening until cancelled
- › Actuation: potential-free contact
- › Dimensions: 125 x 125 x 53 mm
- › Installation: surface-mounted casing IP54
- › Programming: using programming button in the lock
- › Response: see page 18



ÜLOCK CABLE



Practical 2 core cable



ÜLock-B Cable safety lock



Compact I/O module EWS Eco



TWICE AS EASY WITH THESE THREE!

Trio for more security

Performance spectrum:

- › **First Class:** Highest standard upper class quality for more security
- › **Effective also for long-range use:** Enables up to 20 m distance between ÜLock and I/O module
- › **Your data are treated confidentially:** Permanently coded data transfer ensures an optimal protection against data manipulation
- › **We are versatile:** All relevant status messages are available
- › **Do you value flexibility?** Here you can easily choose between short-time and permanent unlocking
- › **For constant security:** Extended process safety
- › **A reliable partner also for emergencies:** ÜLock-B Cable including panic function and mechanical emergency open function through the profile cylinder
- › **Quick opening on command:** ÜLock outside handle can be electrically engaged
- › **Ease of operation:** Operating voltage 12V DC

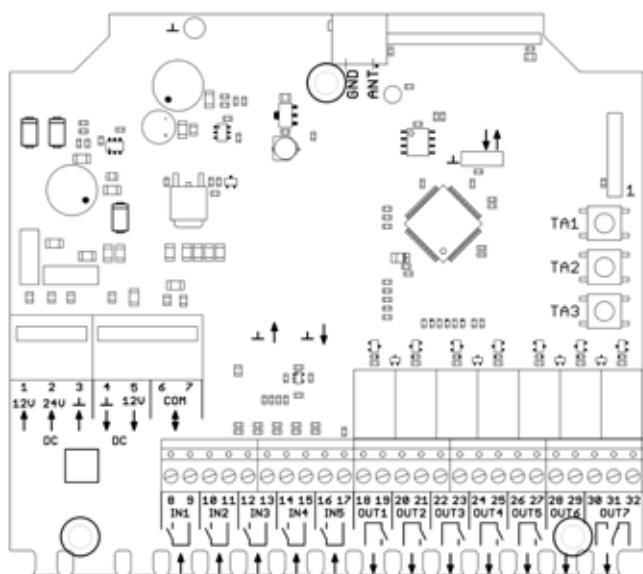

1	+ 12VDC IN
2	+ 24VDC IN
3	GND IN
4	GND OUT
5	+ 12V DC OUT (max. 200mA)
6/7	Connection to the ÜLock Cable
IN 1	Short-time unlocking
IN 2	Open (OPEN)
IN 3	Close (CLOSED)
IN 4	Edge-triggered opening and closing
IN 5	Outside door contact
Out 1	Door closed (NO) ("Latch locked" NO AND „ext. door contact" closed) Out
Out 2	Cylinder key activated (NO)
Out 3	Handle 1 activated (NO)
Out 4	Handle 2 activated (NO)
Out 5	Locked(NO) ("Latch locked" AND "Handle disengaged")
Out 6	Sabotage (NC)
Out 7	Handle engaged (NO) / Handle disengaged (NC)

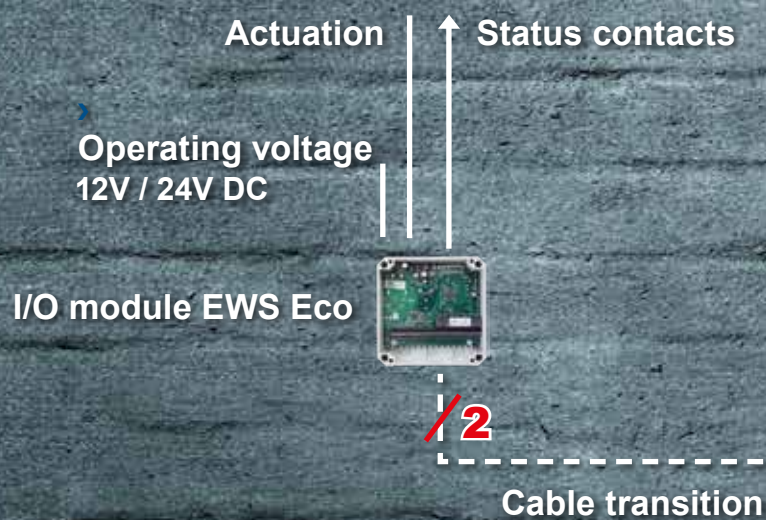

ÜLOCK CABLE



FULL LEAF Premium

Product features of ÜLock-B and ÜLock-Z:

- › Hub: 9 mm
- › Cylinder: Profile cylinder (PZ), round cylinder (RZ)
- › Self locking, whisper latch 20 mm (stainless steel)
- › Mains voltage and actuation with the aid of a connector cable (2 core, to connect the lock with the I/O module EWS Eco)
- › Tamper-proof data transfer
- › Potential-free response at the I/O module available

Specification ÜLock-B:

- › Outside handle can be connected electrically
- › Panic function
- › Certificates: EN 179 / EN 1125 / EN 1634-1

Specification ÜLock-Z:

- › Both handles can be engaged electrically
- › No panic function!
- › Premium version incl. certificate: EN 1634-1





Connector cable:

- › 2 core



I/O module EWS Eco

Distance	Backset	Flying mullion (polished stainless steel) Standard rounded			
 DIN PZ					
		20x235x3	24x235x3	20x280x3	24x280x3
72	55	X	X		
72	60	X	X		
72	65	X	X		
72	80	X	X		
92	65			X	X
92	80			X	X
 Ö-Norm PZ					
		18x250x3	20x250x3	20x300x3	
88	55	X	X	X	
88	60	X	X	X	
88	65	X	X	X	
88	70	X	X	X	
 RZ					
		20x235x3	24x235x3	18x230x3	20x230x3
74	65	X	X		
78	60			X	X
78	70			X	X
78	80			X	X

Highlighted in blue = In-stock items (readily available)

Strike plates are **NOT** provided.

Suitable strike plates shown on page 24.



I/O MODULE EWS ECO

The I/O module allows existing access systems to communicate with the Südmittel ÜLock-B Cable. The lock and the I/O module are connected by a two core connector cable. The transferred data are protected against manipulation by an AES 128 coding.

Product features:

- › Mains voltage: 12V DC / 24V DC
- › Unlocking: short time open
long time open until cancelled
- › Actuation: potential-free contact
- › Dimensions: 125 x 125 x 53 mm
- › Installation: Surface-mounted casing IP54
- › Response: see page 18



CONNECTOR CABLE

2 core flexible connector cable for connecting the ÜLock-B Cable with the I/O module EWS Eco.

Product features:

- › Length: 10 m
- › Diameter: 4 mm



CABLE SPIRAL

The standard cable transfer set serves as a line protection in the area of movable to fixed elements such as doors, windows, etc.

Product features:

- › Length: 500 mm
- › Colours: white/silver
- › Inside diameter: 10 mm
- › Outside diameter: 13 mm



CABLE ACCESS POINT MD 1188

Cable spiral incl. cable reel for a concealed run of the connector cable from door leaf to frame.

Product features:

- › Dimensions: 20x346x15 mm (BxHxT)
- › Spiral spring EN 10270-1 DH
- › Length: 337 mm
- › Inner diameter: 8 mm
- › Outer diameter: 10,8 mm
- › Opening angle 180°
- › Corrosiveness category C3, DIN EN ISO 12944-2
- › Max. cable diameter: max. 6 mm
- › Cable loop min. 30 mm at the mounting box or spiral spring

ÜLOCK CABLE SMART



FULL LEAF Premium

The ÜLock Cable Smart allows the door handle to be easily activated electrically by an entry control without requiring a separate control system.

Product features:

- › Hub: 9mm
- › Cylinder: profile cylinder (PZ), round cylinder (RZ)
- › Self locking (whisper latch...)
- › Long-lasting thanks to a very low current draw
- › No separate control system required
- › Mains voltage: 12V DC, max 150mA
- › Simple activation by an "active low" Command direct at the ÜLock
- › The handle is activated as long as the entrance is "low"
- › Response "locked" (2V DC)

Specification ÜLock-B:

- › Outside handle can be engaged electrically
- › Panic function
- › Certificates: EN 179 / EN 1125 / EN 1634-1 / EN 14846



Specification ÜLock-Z:

- › Both handles can be electrically engaged
- › No panic function!
- › Premium version incl. certificates: EN 1634-1 / EN 14846



Connector cable

Flexible connector cable, compatible with ÜLock-B Cable Smart

Distance	Backset	Flying mullion (polished stainless steel) Standard rounded			
 DIN PZ					
		20x235x3	24x235x3	20x280x3	24x280x3
72	55	X	X		
72	60	X	X		
72	65	X	X		
72	80	X	X		
92	65			X	X
92	80			X	X
 Ö-Norm PZ					
		18x250x3	20x250x3	20x300x3	
88	55	X	X	X	
88	60	X	X	X	
88	65	X	X	X	
88	70	X	X	X	
 RZ					
		20x235x3	24x235x3	18x230x3	20x230x3
74	65	X	X		
78	60			X	X
78	70			X	X
78	80			X	X

Highlighted in blue = In-stock items (readily available)

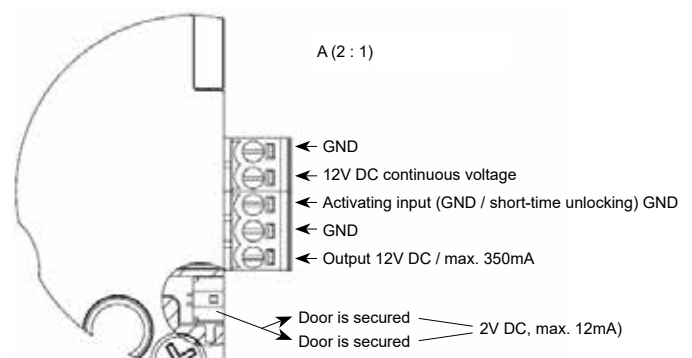





FULL BLATT Premium

Product features:

- › Self locking, whisper latch 20 mm (stainless steel)
- › Mechanical securing of progress
- › Separated hub: 9 mm
- › Cylinder: profile cylinder (PZ), round cylinder (RZ)
- › Can be used in combination with the ÜBar panic rod
- › Available with a continuous hub on request

Specification ÜLock-B:

- › Outside handle can be mechanically engaged
- › Panic function
- › Premium version incl. certificates:
EN 179 / EN 1125 / EN 1634-1 / EN 14846

Distance	Backset	Flying mullion (polished stainless steel) Standard rounded			
 DIN PZ					
		20x235x3	24x235x3	20x280x3	24x280x3
72	55	X	X		
72	60	X	X		
72	65	X	X		
72	80	X	X		
92	65			X	X
92	80			X	X
 Ö-Norm PZ					
		18x250x3	20x250x3	20x300x3	
88	55	X	X	X	
88	60	X	X	X	
88	65	X	X	X	
88	70	X	X	X	
 RZ					
		20x235x3	24x235x3	18x230x3	20x230x3
74	65	X	X		
78	60			X	X
78	70			X	X
78	80			X	X

Highlighted in blue = In-stock items (readily available)

Strike plates are **NOT**
included.

Suitable strike plates
can be found on page 24.

NOTICE:

To enter from outside both handle and profile cylinder must be activated at the same time - NO alternate function!



ÜLOCK STRIKE PLATES

for full leaf doors

Strike plates for use in combination with the ÜLock Battery, ÜLock- Cable or ÜLock Basic.

Product features:

- › Material: stainless steel
- › DIN-L rebated door /
DIN-R rebated door

Dimensions:

170 x 20 x 3 mm



ÜLOCK STRIKE PLATES

for full leaf doors

Strike plates for use in combination with the ÜLock Battery, ÜLock Cable or ÜLock Basic.

Product features:

- › Material: stainless steel
- › DIN-L non-rebated door /
DIN-R non-rebated door

Dimensions:

170 x 24 x 3 mm



ÜLOCK ANGLE STRIKE PLATES

for full leaf doors

Strike plates for use in combination with the ÜLock Battery, ÜLock Cable or ÜLock Basic.

Product features:

- › Material: stainless steel
- › DIN-L rebated door /
DIN-R rebated door

Dimensions:

25_32 x 250 x 2 mm

25_15 x 250 x 2 mm



ÜLOCK U STRIKE PLATES

for full leaf doors

Strike plates for use in combination with the ÜLock Battery, ÜLock Cable or ÜLock Basic.

Product features:

- › Material: stainless steel
- › DIN-L rebated door /
DIN-R rebated door

Dimensions:

28 x 170 x 8 mm

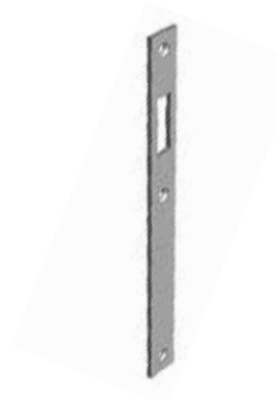

ÜLOCK STRIKE PLATES

for tubular frame doors

Strike plates for use in combination with the ÜLock battery.

Product features:

- › Material: stainless steel
- › DIN L/R can be used

Dimensions:

245 x 24 x 3 mm
270 x 24 x 3 mm
245 x 30 x 1,5 mm
270 x 28 x 3 mm



FLYING MULLION REINFORCEMENT

for tubular frame doors

With the help of this flying mullion reinforcement the installation of the ÜLocks can be adapted to the respective profile construction and the air gap in the area of the lock can be adjusted.
For reinforcing flying mullion or strike plates.

Product features:

- › Material: stainless steel
- › DIN L/R can be used

Dimensions:

245 x 24 x 3 mm
245 x 24 x 2 mm
270 x 24 x 3 mm

Customisation available upon request!



ÜLOCK STRIKE PLATES

for full leaf doors

Strike plates for use in connection with ÜLock Inductive.

Product features:

- › Material: stainless steel
- › Incl. transmitting unit
- › DIN-L non-rebated door /
DIN-R non-rebated door
- › Loop: 40 x 80

Dimensions:

190 x 24 x 3 mm



ÜLOCK STRIKE PLATES

for full leaf doors

Strike plates for use in connection with ÜLock Inductive.

Product features:

- › Material: stainless steel
- › Incl. transmitting unit
- › DIN-L rebated door /
DIN-R rebated door

Dimensions:

190 x 20 x 3 mm



ÜLOCK ANGLE STRIKE PLATES

for full leaf doors

For use in connection with ÜLock Inductive.

Product features:

- › Material: stainless steel
- › Incl. transmitting unit
- › DIN-L / DIN-R
- › Round or angular

Dimensions:

25_32 x 250 x 2 mm

25_15 x 250 x 2 mm



ÜLOCK U STRIKE PLATES for full leaf doors

Strike plates optimised for steel frames for use in connection with ÜLock Inductive.

Product features:

- › Material: stainless steel
- › Incl. transmitting unit
- › DIN-L / DIN-R

Dimensions:

190 x 25 x 1,5 mm



ÜLOCK U STRIKE PLATES for full leaf doors

Strike plates optimised for steel frames for use in connection with ÜLock Inductive.

Product features:

- › Material: steel, silver painted
- › Incl. transmitting unit

Dimensions:

170 x 28 x 8 mm



ÜLOCK STRIKE PLATES for tubular frame doors

Strike plates optimised for steel frames, for use in connection with ÜLock Inductive.

Product features:

- › Material: stainless steel
- › Incl. transmitting unit
- › DIN-L / DIN-R universal

Dimensions:

245 x 24 x 3 mm

270 x 24 x 3 mm

270 x 28 x 3 mm

Customisation available upon request!



Locking systems combining comfort with security are becoming increasingly important today. The electronic knob cylinder "ÜLinder" from Südmittel can be installed both in small as well as in medium-sized doors. ÜLinder is a universally useable locking unit.

It allows almost unlimited combination options; the variable length of the cylinder enables it to be installed into all doors. The compatibility of the cylinder with common mortice locks allows a simple retrofit.

MODULAR CONSTRUCTION

The modular construction allows for a maximum flexibility.

An ÜLinder consists of the following components (must be ordered separately):

Electronic knob



Profile cylinder, half cylinder or round cylinder



Inside knob or electric knob



- Can be easily refitted with existing doors.
- Can be used in escape routes and emergency fire doors.
(According to the respective version)
- Flexible actuation

Sealed, water-protected knob in the casing (IP 66 according to the respective version).

Can be used with electronic systems according to DIN 18252 and DIN EN 1303.

Knob

- Electronic knob, 40 mm and 45 mm
- Battery operated (two batteries: CR2 lithium 3V)
- Casing made of nickel-plated brass and a hard plastic cover
- Simple installation with the knob module snapping into place in the cylinder

Inside knob

- Inside knob mechanical 29 mm and 34 mm



Zylinder

- Different lengths available
- Cylinder, nickel plated brass

ÜLINDER OVERVIEW STANDARD

ÜLINDER STANDARD

Universally useable electronic cylinder suitable for all kinds of installations.
Cylinder lengths range from 26/26 and 30/30 to 200/200 in 5 mm increments.



ELECTRONIC CYLINDER

The knob cylinder is an electronic locking cylinder that authorises access only on one side that is available in different cylinder lengths. You may choose between the inside and the outside area (protection category IP66). The cylinder is available either standalone or as a software solution.



ELEKTRONIC HALF CYLINDER

With the electronic half cylinder doors can be fitted on one side only. You may choose between the inside and the outside area (protection category IP66). The cylinder is available either standalone or as a software solution.



ELECTRONIC DOUBLE KNOB CYLINDER

The double knob cylinder is an electronic locking cylinder featuring a two-sided, separated electronic access authorisation. The cylinder controls access from both sides of the door. The access authorisation is recorded on both sides of the door. You may choose between the inside and the outside area (protection category IP66). The cylinder is available either standalone or as a software solution.





ÜLINDER COMPACT

Narrow knob can be used for example with tubular frame doors.
Cylinder lengths from 26/26 and 30/30 to 200/200 in 5 mm increments.



ELECTRONIC CYLINDER

The knob cylinder is an electronic locking cylinder with a small diameter as an ideal solution for tubular frame locks. The complete mechanics and electronic has been assembled protected inside the cylinder. It also possesses an integrated mechanical protection against drilling. You may choose between the inside and the outside area (protection category IP66). The cylinder is available either standalone or as a software solution.



ELECTRONIC HALF CYLINDER

The half cylinder is an electronic locking cylinder with a small diameter as an ideal solution for tubular frame locks. The complete mechanics and electronic has been assembled protected inside the cylinder. It also possesses an integrated mechanical protection against drilling. You may choose between the inside and the outside area (protection category IP66). The cylinder is available either standalone or as a software solution.

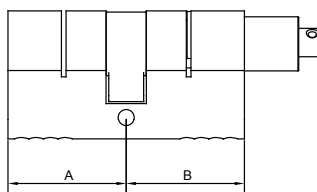
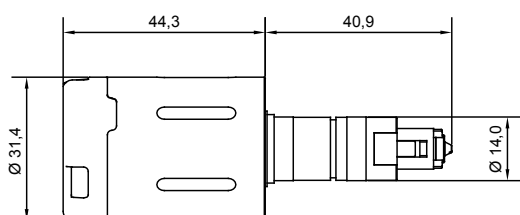



ÜHANDLE

The ÜHandle can be installed in most commercially available doors; it controls the access electronically.

Extremely flexible, the electronics, mechanics, LED signalling and power supply is completely assembled in the smallest space in the door handle.

Available in round rose and oval rose versions. The oval rose type also fits doors with very narrow frames.

The timeless and plain stainless steel design adapts itself discretely to surroundings both in new and existing buildings.



Product features:

- › Corresponds to the common European locking standards
- › Existing locks can be used
- › Range of different handles available (Ronny, Hanna, Paula)
- › Wireless
- › Electronic mechanism automatically activated by simply holding the key against the handle (passive transponder used as a card or a transponder tag)
- › Permanently engaged without drawing more power
- › Certified for emergency fire doors and for smoke control doors according to DIN EN 1634 (depending on the type)
- › Certified for emergency exit locks according to DIN EN 179 (depending on the type)





THE ÜHANDLE IS AVAILABLE IN A VARIETY OF SHAPES.



RONNY



HANNA



PAULA

LONG, WIDE AND SHORT HANDLE SETS AVAILABLE IN MOST COMMON EUROPEAN DISTANCES BETWEEN SCREWS.

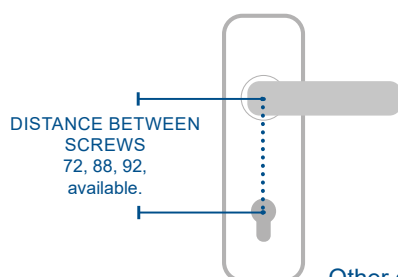

Other distances between screws available upon request!





ÜHANDLE ROUND ROSE

Product features:

- › Material: stainless steel
- › Rigidly/pivot mounted
- › Top Speed quick assembly system
- › Round rose Ø 55 mm
- › Pin thickness 8, 8.5, 9 and 10 mm
- › Certified for emergency fire doors and smoke control doors DIN EN1634 (depending on the type)
- › Certified for emergency exit locks DIN EN 179 (depending on the type)
- › Profile cylinder (PZ), round cylinder (RZ) or blind rose boring
- › Suitable for inside and outside area (IP66)
- › Mifare Classic 1k/4k and Desfire EV1/EV2

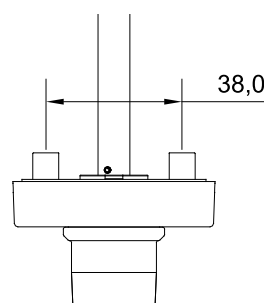
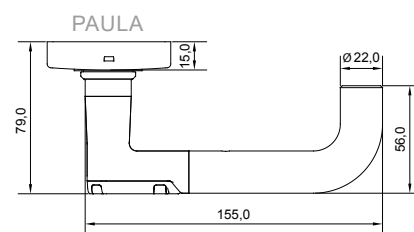
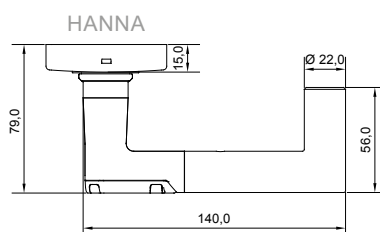
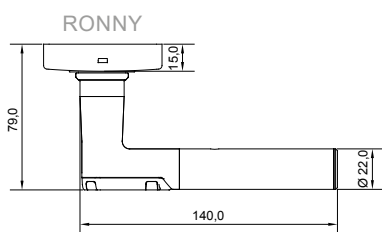



ÜHANDLE OVAL ROSE

Product features:

- › Material: stainless steel
- › Rigidly/pivot mounted
- › Top Speed quick assembly system
- › Oval rose length 66 mm, width 36 mm
- › Pin thickness 8, 8.5, 9 und 10 mm
- › Certified for fire emergency doors and for smoke control doors DIN EN1634 (depending on the type)
- › Certified for emergency exit locks DIN EN 179 (depending on the type)
- › Profile cylinder (PZ), round cylinder (RZ) or blind rose boring
- › Suitable for indoor and outdoor area (IP66)
- › Mifare Classic 1k/4k and Desfire EV1/EV2

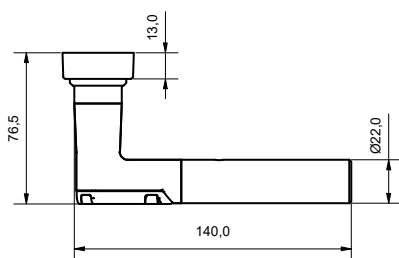
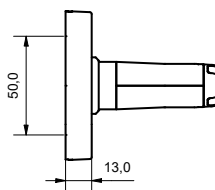
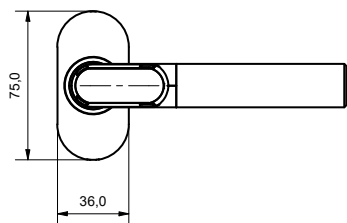



ÜHANDLE WIDE HANDLE SET

Product features:

- › Material: stainless steel
- › Rigidly/pivot mounted
- › Wide handle set length 290.8 mm, width 64.4 mm
- › Easily retrofitted through compatibility with standard rose drill holes (38 mm)
- › Pin thickness 8, 8.5, 9 and 10 mm
- › Certified for fire emergency doors and for smoke control doors DIN EN1634 (depending on the type)
- › Certified for emergency exit locks DIN EN 179 (depending on the type)
- › Profile cylinder (PZ), round cylinder (RZ) or blind rose boring
- › Suitable for indoor and outdoor area (IP66)
- › Mifare Classic 1k/4k and Desfire EV1/EV2

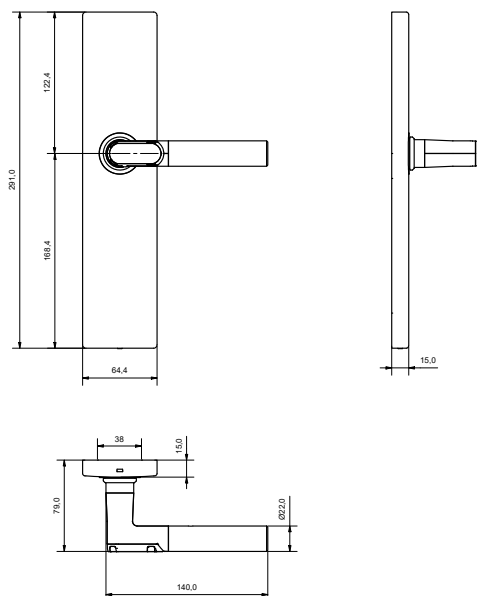



ÜHANDLE SHORT HANDLE SET

Product features:

- › Material: stainless steel
- › Rigidly/pivot mounted
- › Short handle set length 170 mm, width 46 mm
- › Pin thickness 8, 8.5, 9 and 10 mm
- › Certified for fire emergency doors and for smoke control doors
DIN EN1634 (depending on the type)
- › Certified for emergency exit locks DIN EN 179 (depending on the type)
- › Profile cylinder (PZ), round cylinder (RZ) or blind rose boring
- › Suitable for indoor and outdoor area (IP66)
- › Mifare Classic 1k/4k and Desfire EV1/EV2

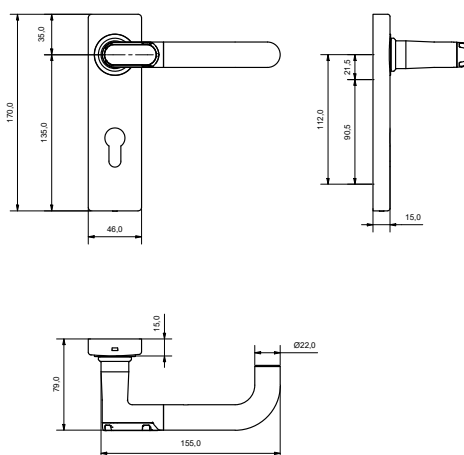



ÜHANDLE NARROW HANDLE SET

Product features:

- › Material: stainless steel
- › Rigidly/pivot mounted
- › Narrow handle set length 290.8 mm, width 42.4 mm
- › Easily retrofitted through compatibility with standard drill holes (50 mm)
- › Pin thickness 8, 8.5, 9 and 10 mm
- › Certified for fire emergency doors and for smoke control doors
DIN EN1634 (depending on the type)
- › Certified for emergency exit locks DIN EN 179 (depending on the type)
- › Profile cylinder (PZ), round cylinder (RZ) or blind rose boring
- › Suitable for indoor and outdoor area (IP66)
- › Mifare Classic 1k/4k and Desfire EV1/EV2

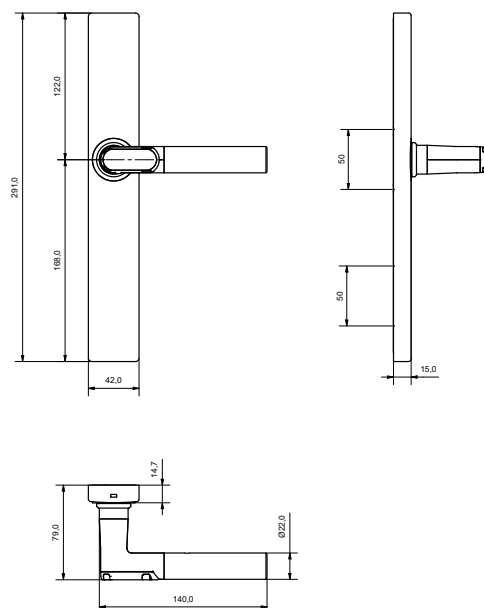



BATTERY REPLACEMENT TOOLS

Special tools are needed for replacing batteries. These must be ordered separately to fit the ÜLinder.

The case of the ÜLinder compact can be removed using a magnet.

With the aid of a battery clip the locking pins of the ÜLinder Standard can be pushed in and then the case can be pulled off when the unlocking pins have been released by an electronic access authorisation.



WIRELESS SWITCH MODULE

To activate ÜLinders and ÜHandles (standalone version) using third-party reader interface with a potential free contact.

- Connection voltage: 8-12V DC
- Dimensions: 65 x 50 x 37



EMERGENCY POWER ADAPTER

For ÜLinder standard



PIN AND SCREW SET FOR ÜHANDLE

For suitable types see the price list.

ACTUATION ÜLOCK BATTERY USING A WIRELESS BATTERY KEYPAD

PERFECT FOR RETROFITTING

WIRELESS KEYPAD

- › High-grade surface-mounted casing
- › Allows up to 99 PIN codings
- › Between 1 and 8 figures for user codings selectable
- › Either battery operated or using 12V DC
- › Blue background illumination (only 12V DC)
- › LED display (output is green and red; menu is orange)
- › Available in different colours



SECURITY

- › Door permanently locked (self locking)
- › Coded data transfer between keypad and lock
- › Can be used with fire emergency doors and panic doors
- › Can be mechanically opened using a profile cylinder

COMFORT

- › Easy to operate / Activated with a keypad
- › Features 99 different user codings
- › Comfortable entry, activation of the handle opens the door
- › Permanent opening mode can be set using the keypad
- › Wireless battery operation



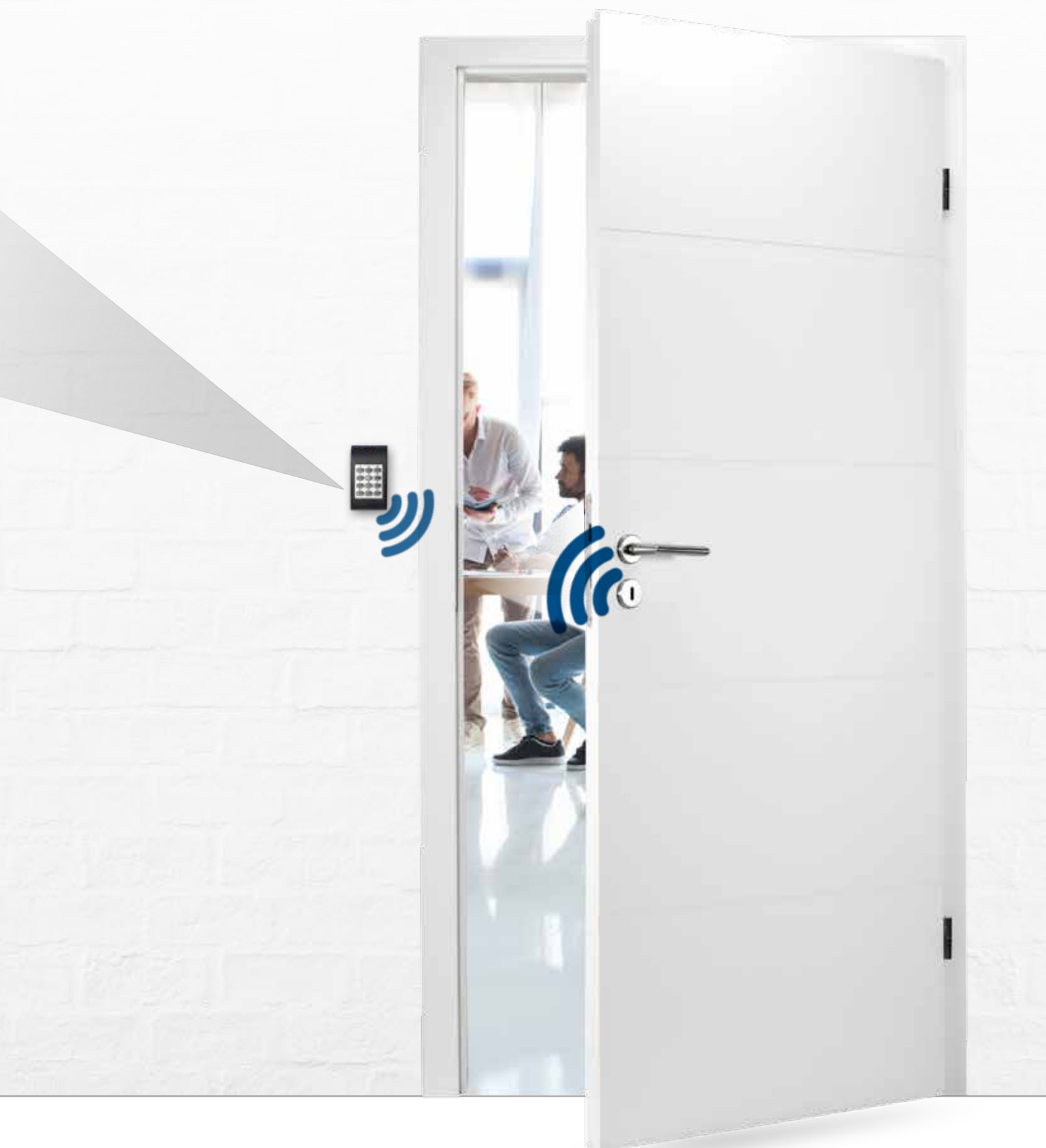

VOXIO TOUCH STAND ALONE

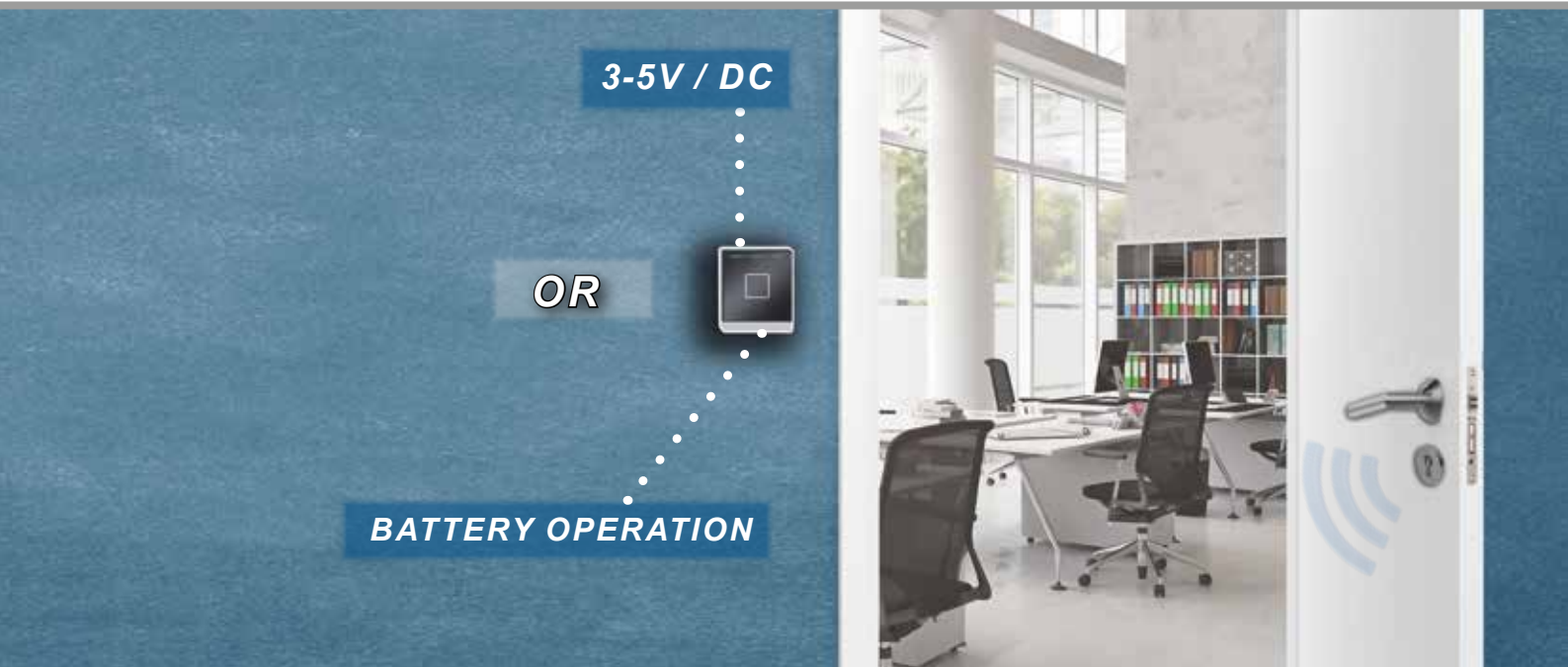

VOXIO WALL READER

The wall reader is available either battery operated or for use with an external supply voltage. Useable both standalone or as a system solution with software.

Product features:

- › Installation: Surface mounted or concealed, dust and water-proof (IP 54)
- › Compatible with various card standards:
 - ISO 14443A/B, Legic Prime / Advant
 - Mifare classic / DESFire, INSIDE (only UID)
 - SonyFeliCa (only UID)
- › Up to 320 access authorisations for each reader
- › Wireless interface integrated in the reader (868 MHz / AES 128 coded)
- › Tamper-proof transfer
- › Easy to engage with the lock
- › No I/O module required
- › Attractive modern design



Features:

- › Connected to the reader by the programming device "NMT"
- › Software supported administration of the users and the user groups
- › Protocols can be read out
- › Frequency 868.3 MHz with ÜLock, coding AES 128

STANDALONE OPERATION

With master cards



Features:

- › No software
- › Group master cards
- › Easy administration by arranging groups of persons
- › Groups of persons can be stored specifically in different readers
- › Individual groups of persons can be deleted





ÜLOCK + VOXIO TOUCH READER

A PERFECT SYMBIOSIS FOR SYSTEM PROVIDERS

- › Using Voxio Touch Reader the ÜLock remote control lock can be activated directly
- › Easy access to all status information
- › ÜLock Battery wireless lock replaces door opener, motor locks, etc...
- › Wireless: Easy to refit without causing physical alterations

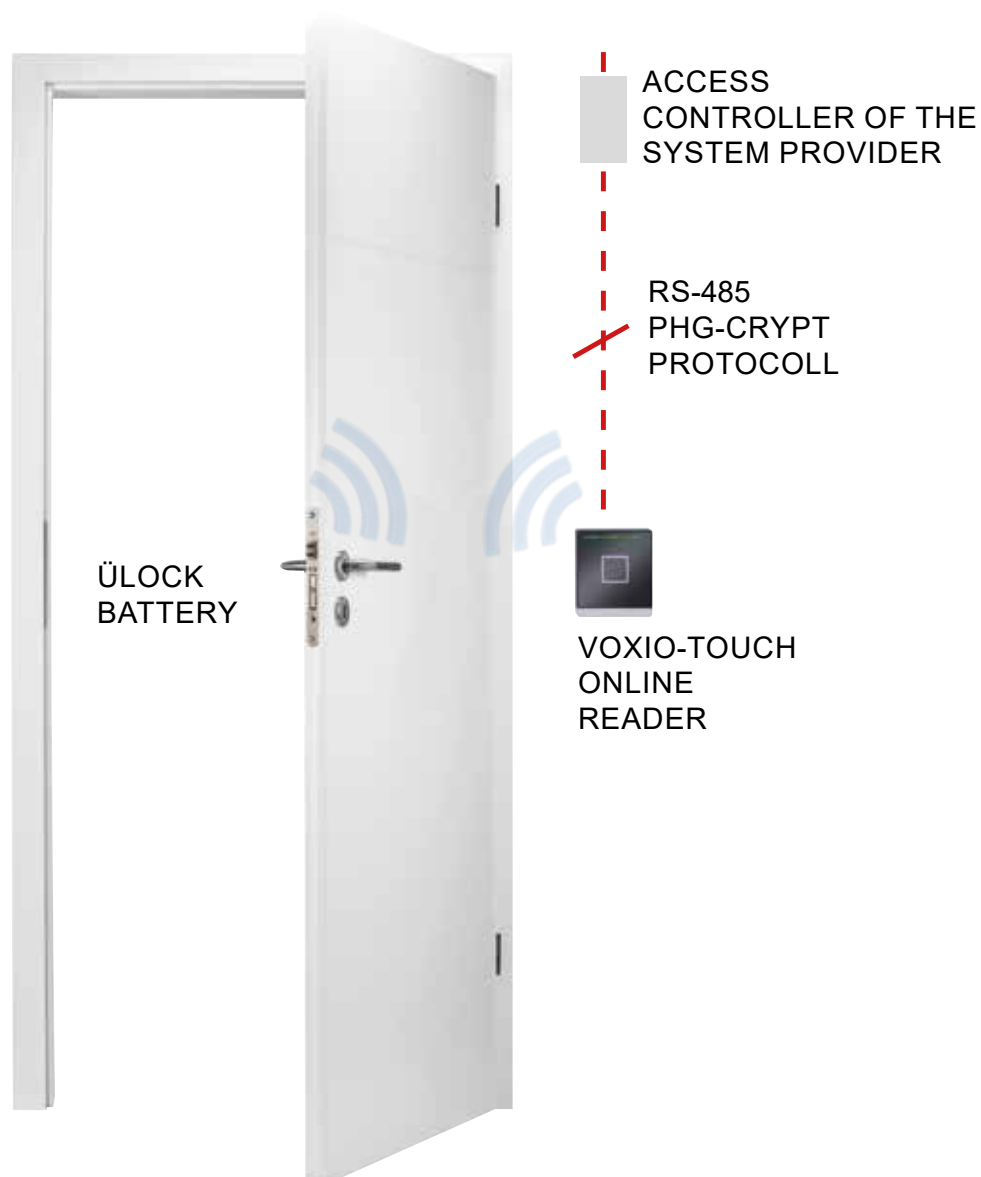

ÜLOCK BLE



The ÜLock BLE allows doors to be opened with a Smartphone. The Smartphone is automatically connected with the ÜLock through Bluetooth as soon as it comes close to the door. The actuation will then take place with the aid of the corresponding Handy App solution. This system is ideal for offices, surgeries, hotels, holiday homes and for many other uses.

ÜLOCK BATTERY / INDUCTIVE

The locks ÜLock Battery and ÜLock Inductive are available as BLE versions. These locks can be easily activated using a Smartphone.

The vendors listed in the following provide Apps which are compatible with the ÜLock BLE.

The ÜLock BLE also enables integration with various BLE capable access control systems.
(In cooperation with the ZK provider)

Product features:

- › Outside handle can be engaged electrically (via BLE)
- › Panic function
- › Self locking whisper latch 20 mm (stainless steel)
- › Remote control and electronic protected in the lock casing
- › Radio frequency BLE 2.4 GHz
- › Locks can be operated either with batteries or inductive
- › Premium version incl. certificates
(EN 179 / EN 1125 / EN 1634-1 / EN 14846)

ÜLock-BLE can be integrated into various platforms for Cloud access control systems. In addition to the established general performance features of the ÜLock, it will then additionally take on the specific functions of the respective system platform.





KleverKey can be used to easily and comfortably administrate digital access authorisations. This is done either directly with the KleverKey App or through the KleverKey portal (my.kleverkey.com).

KleverKey is an independent system for administrating access authorisation from Switzerland.

Product features:

- › Actuation through BLE using KleverKey App
- › Access authorisation optionally one-off / for 24h / according to individual time profile (Cloud prompting before being released)
- › Permanent access authorisation (with no Cloud prompting possible)
- › Administration via Cloud (data protection): access authorisation of users, administration of time profiles, access to event log, information on "low battery"
- › Site navigation function
- › High Security Standards (eBanking Standard)



Digital access authorisation can be flexibly assigned with the help of Cloud and transferred to the final user. The administration can be carried out by any web-enabled mobile device or computer.

This platform is equally suitable for small buildings with only one door as well as for large buildings.

Bitwards is an independent system for administrating access authorisation from Finland.

Product features:

- › Actuation via BLE through the Bitwards App
- › Easy installation and transferral of the administrator rights to the operator
- › Time plans for creating individual rights
- › Administration via Cloud (data protection): User access authorisation, administration of time profiles, access to event logs, information on "low battery"
- › Site navigation function
- › High Security Standards
- › Multi Account Administration



Flintec is a German specialist for mobile time recording and access control. In addition to the classical actuation through Mobile App, Flintec is specialised in NFC compatible solutions featuring a tablet or a wall reader positioned as an interface of ÜLock, NFC and Cloud next to the door.

Product features:

- › Actuation through BLE using the Flintec App
- › Smartphone and NFC can be combined with the aid of wall readers or tablets
- › Time plans for creating individual rights
- › Administration via Cloud (data protection): User access authorisation, administration of time profiles, access to event logs, information on "low battery"
- › Site navigation function
- › High Security Standards
- › Multi Account Administration

ÜMANAGEMENT 2.0



...offers those responsible for building security a high degree of comfort and can therefore be recommended for the smallest buildings as well for large buildings with a large number of users. A software system allows the individual control of access to a building.

For example, access can be restricted to certain days of the week or also to specific hours of the day.

The system can also be individualised by creating user groups with different access rights. The data can be easily transferred to Mifare cards using a PC card reader - ACCESS ON CARD.

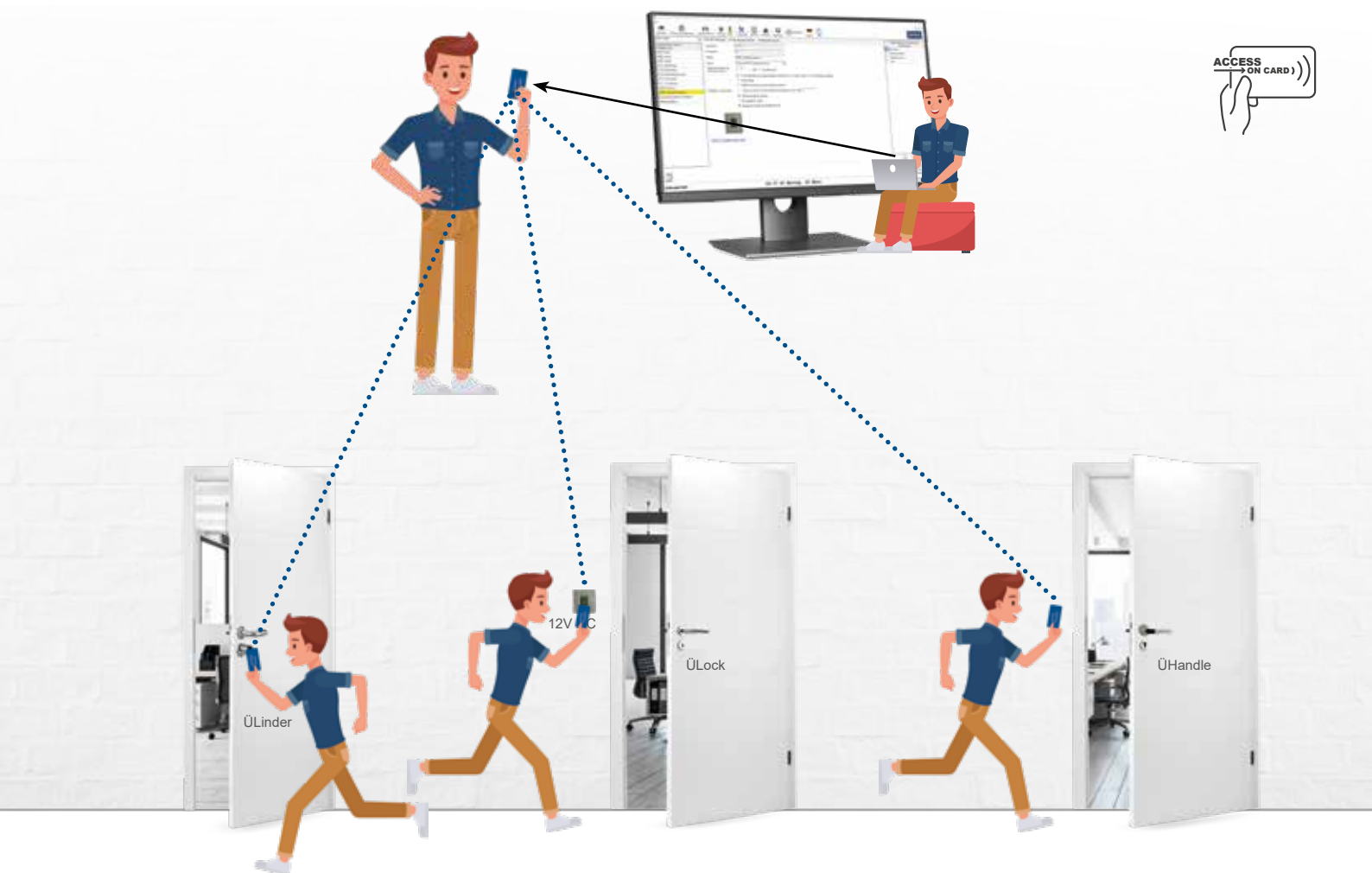



FEATURES

FLEXIBLE INSTALLATION

- Standard
Customary ease of installation on a computer / Single user version
- SQL Server Installation
For being operated by several workstations

MANAGEMENT OR PROFESSIONAL OPERATIONAL MODE

- Management mode
 - Access authorisation is always allocated to a user group
 - Efficient handling / organisation
 - Ideal for small buildings
- Professional mode
 - Access authorisation can be assigned directly for up to 5 doors (can also be assigned to user groups / e.g. apartment and common rooms)
 - Comprehensive organisational options available

ALLOWS STANDARD ADMINISTRATION OF VARIOUS LOCKS

- ÜLock
- ÜLinder
- ÜHandle

ADVANTAGES

FOR THE USER

- Only one transponder and not a complete set of keys required
- Low risk with the loss of a transponder

FOR THE OPERATOR

- More comfort and security (e.g. through individual rights / automatic locking e.g. of the entrance)
- No licence fees
- Optimised for retrofitting

FOR THE IN-HOUSE TECHNICIAN

- Easy to use software
- Flexible functions
- Automatic assignment of additional access authorisation (e.g. for entrance door / meeting room)

BENEFIT

INDUSTRY / OFFICES

- Flexible access for staff

HOMES FOR THE ELDERLY

- Mrs Huber is given access rights
 - to her apartment
 - Entrances
 - Wellness during the opening hours

HOTEL / APARTMENTS

- Very easy for issuing of guest cards
- Points system e.g. for using Wellness / gym / ...

CLUB / CLUB HOUSE

- Very easy to administrate, no prior knowledge required
- Flexible organisation (e.g. time zones / access rights for new club members ...)



ÜMANAGEMENT 2.0 SOFTWARE

Access on Card Software for use in organising and administrating access authorisation. The software enables a comfortable management of buildings of all sizes. The software's compatibility with a variety of locks provides a maximum degree of flexibility for an installation, especially in already existing buildings.



Product features:

- › Compatible products: ÜLock, ÜHandle, ÜLinder
- › Coded data transfer
- › Access on Card: user access authorisation stored on identification medium using desk-top reader
- › Structure: user/user groups
- › Time management: time zones/weekdays
- › Access authorisation: definable time-wise
- › Event log can be read out with the help of a "reading card"
- › Right of access: individually programmable
- › Operating system: Windows 7 and updates
- › Standard or SQL Server Installation
- › Credit function: fill with points, points deducted with each access

Performance features:

- › 250 buildings
- › 250 hallways per building
- › 68.000 ÜLinder or ÜHandle
- › 15.000.000 ÜManagement RFID reader
- › Users with use of ÜManagement RFID readers: unlimited
- › Users with use of ÜLinder or ÜHandle: 68,000
- › RFID Identification means: Mifare DESFire EV1, EV2 and Mifare Classic 1k, 4k
- › Time zones: unlimited
- › Times per time zone: 2





ÜMANAGEMENT RFID READER

RFID wall reader for a direct wireless actuation of an ÜLock. As an orientation aid the luminary of the wall reader can be on in white. The colour green confirms access authorisation while red indicates the absence of access authorisation.



silver



white



anthracite

Product features:

- › Actuation ÜLock: radio frequency 868.3 MHz
- › Card/Transponder format: Mifare Classic 1k/4k and DESFire EV1/EV2
- › Scanning distance: max. 6 cm
- › Configuration: Configuration card is programmed with the aid of the ÜManagement 2.0 software
- › Operating voltage: 12V DC
- › Dimension: 80 x 80 x 28 mm
- › Installation: standard flush box
- › Event log: readout
- › Surface: plastic
- › Cover frame colour: silver, anthracite, white
- › Illuminant colour: white, green, red





ÜLOCK-B BATTERY

Display stand featuring an ÜLock-B Battery full leaf lock and a wireless handheld transmitter.



ÜLOCK-B INDUCTIVE

Display stand featuring an ÜLock-B Inductive full leaf lock and a wireless handheld transmitter.



ÜLOCK-B INDUCTIVE

Display stand featuring an ÜLock-B Inductive tubular frame lock and a wireless handheld transmitter.



ÜLOCK-B BATTERY FOR GLASS DOORS

Display stand featuring an ÜLock-B Battery wireless safety lock for glass doors and a wireless handheld transmitter.



ÜMANAGEMENT READER

Display stand featuring an ÜManagement RFID reader, incl. a wall plug transformer.



ÜBAR

Display stand featuring an ÜLock-B Battery full leaf lock in combination with the panic bar "ÜBar" and a wireless handheld transmitter.



ABACO

ABACO is a surface with antibacterial and antiviral properties made by our company. It provides an effective protection against bacteria, germs and in particular against Corona viruses. The surface finishing is extremely durable and resistant to wear. Door mountings such as the panic bar ÜBar are available with a hygienic ABACO surface.

The effectiveness is guaranteed for more than 20 years (see warranty on our Webpage). More information is available in the brochure 36.06.4781 or at www.suedmetall.com.



PAULA II - R

Lever featuring a sturdy metal substructure, pivot-mounted on rose, spring for maintaining a raised position, Top Speed Comfort ball bearing, fixed/turnable mounted high speed assembly system,

without locking screw, for highest stress levels! The patented fitting system. Tested according to the EN 1906 user category 3/4, DIN 18273, EN 1634-2, EN 179.



HANNA - R

Fitting featuring a sturdy metal substructure, pivot-mounted on rose, spring for maintaining a raised position, Top Speed Comfort ball bearing, fixed/turnable mounted high speed assembly system,

without locking screw, for highest stress levels! The patented fitting system. Tested according to the EN 1906 user category 3/4, DIN 18273, EN 1634-2, EN 179.



RONNY II - R

Fitting featuring a sturdy metal substructure, pivot-mounted on rose, spring for maintaining a raised position, Top Speed Comfort ball bearing, fixed/turnable mounted high speed assembly system,

without locking screw, for highest stress levels! The patented fitting system. Tested according to the EN 1906 user category 3/4, DIN 18273, EN 1634-2.





RONNY II - R



Narrow frame set featuring a sturdy metal substructure, rose mounted, spring for maintaining a raised position, fixed/turnable mounted, optional assembly with or without the use of dowels. The patented fitting system! Tested according to the EN 1906 user category 4, DIN 18273.



HANNA - R



Narrow frame set featuring a sturdy metal substructure, rose mounted, spring for maintaining a raised position, fixed/turnable mounted, optional assembly with or without the use of dowels. The patented fitting system! Tested according to the EN 1906 user category 4, DIN 18273, fire fittings for emergency exit lock according to DIN EN 179.



PAULA III - R



Narrow frame set featuring a sturdy metal substructure, rose mounted, spring for maintaining a raised position, fixed/turnable mounted, optional assembly with or without the use of dowels. The patented fitting system! Tested according to the EN 1906 user category 4, DIN 18273, fire fittings for emergency exit lock according to DIN EN 179.



SICURA PAULA - LS/LS

Stainless steel long plate set featuring a steel substructure. Optional fixed handle plate, useable right or left, or door handle. Door handle set mounted fixed/turnable. Screwed concealed from the inside; M6 screws.

Core drawing protection (ZA) version features a cylinder protrusion of 11-18mm. Tested according to DIN 18257 ES1/WB2, ES2/WB3, and DIN 18273. Fire fitting for emergency exit lock according to DIN EN 179.



STAINLESS STEEL



ALUMINIUM F1

BERLIN - LS

Narrow frame fittings mounted fixed/turnable, cylinder protrusion 8 - 12 mm with sturdy metal substructure and spring for maintaining a raised position on both sides. Screwed concealed from the inside, M6 screws, designed for heavy duty!



BREMEN - LS

Narrow frame fitting, mounted fixed/turnable, cylinder protrusion 8 - 12 mm with sturdy metal substructure and spring for maintaining a raised position on both sides. Screwed concealed from the inside, M6 screws, designed for heavy duty!



RECTANGULAR PIN DETACHED DIVIDED

Galvanised, split pin, 8 - 9 - 8 mm.



RECTANGULAR PIN PANIC

Galvanised, split pin, 9 mm.



REINFORCEMENT SLEEVES

Adapter sleeves - available in different thicknesses.



ROSE PULLER

Rose puller for clip roses and plates.



SWITCHING POWER SUPPLY.....

...for supplying power to the Südmetall systems provides a suitable solution for all demands and is adapted to the Südmetall components (ÜLock Inductive /RFID Reader). The concealed mains adapters for installation in concealed sockets are especially suitable for a decentralised power supply since a power supply of 230V (for example an electric socket) power source is usually available close to a door.

Alternatively the mains adapter ("machine rail" version) can be installed in a switch cabinet.

With the help of the mains adapters listed below the system will still function in the event of a power failure. This option is especially recommended for very sensitive buildings.



ELTAKO SNT 61

A feature of the Eltako SNT 61 is its integrated autorecovery function (automatic connection after a fault clearance) that provides protection against overheating and excess voltage.



ELTAKO SNT 12

Eltako SBT 12 is an installation unit for devices mounted in series for assembling a support rail DIN-EN 60715 TH35.

1 division unit = 18 mm wide, 58 mm deep.



OTQ 1212Y

The switching power supply OTQ 1212Y is suitable for being mounted flush. Because of its small size and its performance capability, this power adapter allows a large number of uses. Simple to connect, using a plug-in terminal.



PSU 12V24W

The switching power supply is equipped with a protection against excess voltage and a short circuit. A LED display shows whether the output voltage has been applied correctly. The PSU 12V24W 1.4Ah also allows for the use of an emergency power supply through an integrated backup battery LifePo4 1.4A. This allows the power supply of 12V DC to be continued in the event of a power interruption.



	ELTAKO SNT 61	OTQ 1212Y	ELTAKO SNT 12	PSU 12V24W
				
Assembly	Mounted flush	Mounted flush	Support rail	Support rail
Input voltage	230V AC (-20% bis +10%)	230V AC	230V AC (-20% bis +10%)	230V AC
Output voltage	12V DC	12V DC	12V DC	13,8V DC (battery operation: 12,8V)
Power	0,5 A	1,0 A	1,0 A	2,0 A
Battery				1,4 Ah
Efficiency	81 %	83,5 %	83 %	
Stabilised output voltage	±1 %	±0,5 %	±1 %	±0,5 %
Dimensions	45 x 45 x 33 mm	54,5 x 50,8 x 26,1 mm	18 x 58 mm	123 x 93 x 60 mm
Short-circuit-proof	✓	✓	✓	✓



MIFARE CLASSIC KEY FOBS

Mifare Classic key fobs serve as a means of identification and are thus an alternative to the Mifare Classic Cards. The individual data are stored on the transponders so that the RFID reader can tell whether or not the person possesses an access authorisation.

Product features:

- › Material: ABS plastic blue-grey or
ABS plastic blue/ stainless steel
- › Memory capacity: 1 kB

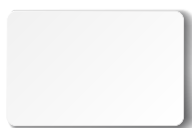

MIFARE CLASSIC CARDS

The Mifare Classic Cards (1kB) serve as a means of identification. The individual data are stored on the card so that the RFID reader can tell whether or not the person possesses access authorisation.

Product features:

- › Mifare Classic 1k
- › Dimensions: 85,6 x 54 mm
- › Colour: Neutral
- › Customised print on request



MIFARE DESFIRE KEY CHAINS



Product features plastic series::

- › Mifare DESFire EV2, 8k, 70pf
- › Material: ABS Novodur plastic
- › Waterproof casing
- › Tamper-proof
- › Durable and unbreakable
- › Dimensions: 34.5 x 43.5 x 5 mm
- › Colour: blue
- › Customised print upon request



Product features stainless steel series:

- › Mifare DESFire EV2, 8k, 70pf
- › Solid polished stainless steel frame
- › Waterproof casing
- › Tamper-proof
- › Dimensions: 36.5 x 45 x 5.2 mm
- › Colour: blue
- › Customised print upon request

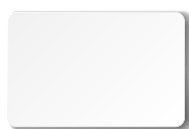

MIFARE DESFIRE CARDS

Plastic cards and chip cards are proven employee ID cards in daily business and as control cards for access to company premises.

Product features:

- › Mifare DESFire EV2, 8k, 70pf
- › Dimensions: 85.6 x 54 mm
- › Colour: neutral
- › Customised print upon request

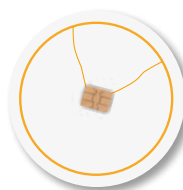

MIFARE DESFIRE LABELS

RFID adhesive labels can be used for a large variety of purposes. Their robust quality and one-sided adhesive surface allows them to be used on almost all surfaces where RFID technology is being used.

The major advantage of an adhesive tag lies in the quick upgrading of an existing medium with an RFID transponder.

Product features:

- › Mifare DESFire EV2, 8k, 70pf
- › Material: PVC
- › Self-adhesive 3M foil
- › Protection category IP68
- › Dimensions: d=27mm / thickness = 0.6mm
- › Colour: white
- › Customised print upon request

ORDERING INFORMATION ÜLOCK

Serie: Battery, Cable or Inductive

Ausführung: Comfort (**untested**),

Premium (**tested** incl. EN 179, EN 1125, EN 14846, EN 1634)

DIN: left/right

Opening direction: opening inwards/outwards

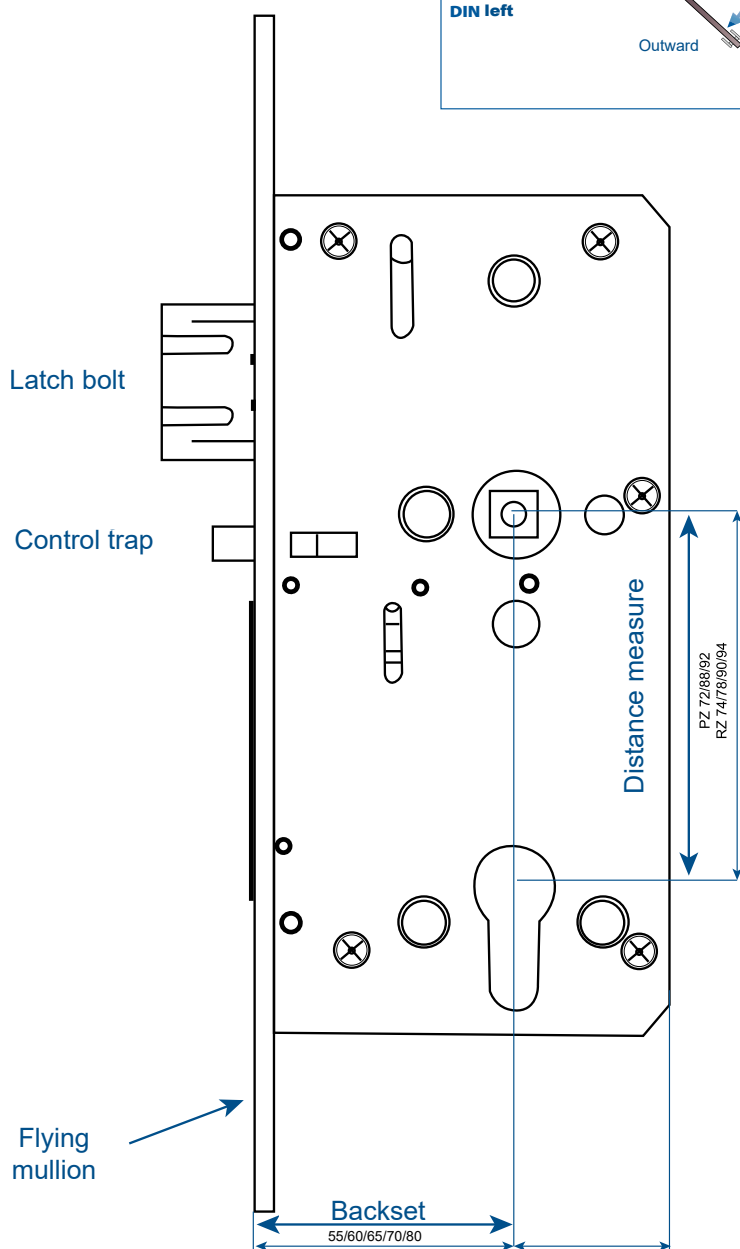
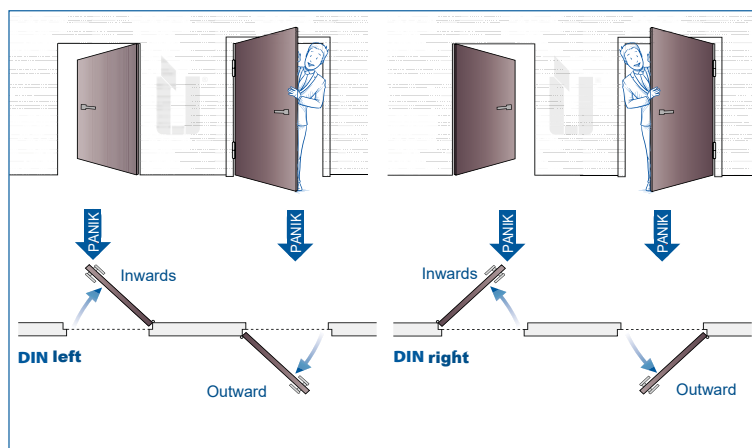

Strike plates are NOT included with ÜLock Battery.

Examples for the overall dimension of the electrical cylinder.

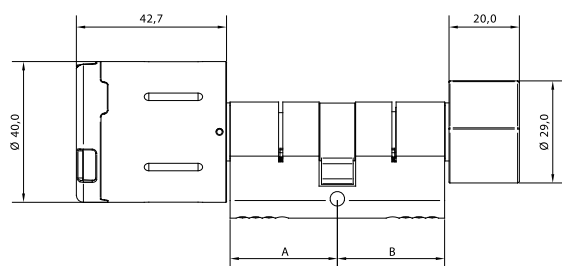

- A** = e. g. locking side in 35 mm
B = e. g. knob side in 35 mm
 = cylinder size, e. g. in 35/35 mm

A / B

Note:

- A** = always outside
B = always inside

Outside = Measurement from the centre of the flying mullion screw to the outer edge of the rose or the fitting on the outside part of the door.

Inside = Measurement from the centre of the flying mullion screw to the outer edge of the rose or the fitting on the inside part of the door.

Minimum dimension of the profile cylinder 26/26 mm or 30/30 mm, each side extendable in 5 mm increments up to a maximum length of 200 mm on each side.

OUTSIDE

INSIDE

Door leaf outside

Door leaf inside

Fixing screw

Rose set

Südmittel has numerous door handle sets in its product range. The catalogue Faszination Beschläge (Art. No. 36.06.0010 with 727 pages) contains our complete assortment.

Cylinder flying mullion screw

Fixing screw

Knob side

Outside overmeasure with rose or fitting

Locking side

Inside overmeasure with rose or fitting

Door thickness

CONTACTS



THOMAS RETTENSTEINER

Sales Manager Locking Systems

Mobil DE: +49 (0) 172 899 95 30
Mobil AT: +43 (0) 676 698 07 28
Email: t.rettensteiner@suedmetall.com



JÖRG BÄRENFÄNGER

Product and Export Manager

Mobil: +49 (0) 172 / 395 09 76
Email: j.baerenfaenger@suedmetall.com



HANS-GÜNTER BLANKENBURG

Technical Advisor Locking Systems,
Architect Consultant
Eastern, Central and Southwestern Germany

Mobil: +49 (0) 172 / 753 22 77
Email: h-g.blankenburg@suedmetall.com



ALEXANDER OEYNHAUSEN

Technical Advisor Locking Systems,
Architect Consultant
Germany North, West

Mobil: +49 (0) 173 / 641 95 68
Email: a.oeynhausen@suedmetall.com



FRANK KRAMER

Sales Manager Süd-Metall Fittings Switzerland

Mobil: +41 (0) 79 850 86 22
Email: f.kramer@ch.suedmetall.com



CLAUDIA TITZE

Assistant Sales Management Locking Systems

Mobil: +49 (0) 8654 4675 61
Email: c.titze@suedmetall.com



Sales & Logistics: Süd-Metall Beschläge GmbH

Sägewerkstrasse 5 | 83404 Ainring / Hammerau | T +49 (0) 8654 4675-50 | F +49 (0) 8654 3672

Email: info@suedmetall.com | www.suedmetall.com

Development & Production: Süd-Metall Schließsysteme Leipzig GmbH

Apelsteinallee 1 | 04416 Markkleeberg | www.suedmetall-schliesssysteme.com

All information provided subject to typographical colour deviations and printing errors.

The terms of payment and delivery on our website apply. The general terms and conditions (AGB) of Süd-Metall Beschläge GmbH apply. Please note the warranty on our website. Art.-No.: 36.06.4765

We, the company SÜD-METALL BESCHLÄGE GMBH, Sägewerkstraße 5, D - 83404 Ainring / Hammerau, are responsible in terms of data protection law. Insofar as you are not yet a customer of ours or if you have not voluntarily provided us with your data to establish contact, your data originate from our own research in resources available through the public domain, e.g. trade directories, network platforms, company registers and the like. Your data are being processed for marketing purposes without your consent according to Section 6 Subsection 1 S. 1 lit f) GDPR to enable us to meet information needs. In all cases you may contact us at any time to object to a future processing of these data for marketing purposes. More information about your other rights, for example regarding information, corrections, deletions, your right to complain and information concerning our data protection official is contained in our data protection declaration which you can access at <https://www.suedmetall.com/4/datenschutz/> and in our information sheet which you can access at https://www.suedmetall.com/fileadmin/user_upload/downloads/Information_Datenschutz_D-EN.pdf.